

Into the 6th Form: Biology at Abingdon

Why study Biology?

Biology truly is the science of the 21st Century, and the AQA A Level course gives an excellent grounding to for further study, or for your interest:

Immunology - how are body responds to disease

- Genetics - how we can understand and change the genetic code
- Environmental science - how our actions affect the Earth
- Human Physiology - how we work as biological systems
- Biochemistry - how our cells work at a fundamental level

Why study at Abingdon?

To put it simply, we have the best facilities and staff, with opportunities to rival any school and most universities. In the Yang Science Centre we have 6 biology laboratories and plenty of breakout spaces for independent research and work. We have a very enthusiastic and well qualified department, made from 7 biology teachers and dedicated 2 technicians.

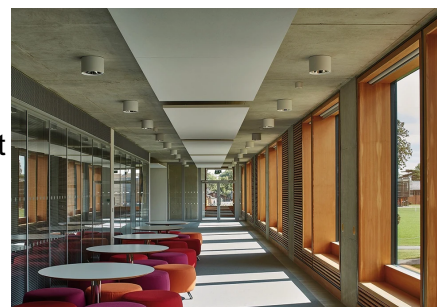

We are also a science of the natural world, so spend as much time as we can investigating it. Using our dedicated Wildlife area and Pond we can sample wildlife on our doorstep, and we run a regular trip to the FSC research centre in South Wales. In addition, every 2-3 years we offer a larger trip with Operation Wallacea to help in conservation research in countries such as Honduras or Madagascar.



If you are interested in applying for any of the applied healthcare degrees, including medicine, dentistry or vet then there are weekly sessions run by the department looking at topics including the importance of work experience, medical ethics, situational judgments tasks, presentation skills and support for application to UK and International Medical Schools. Historically tend to get around 90% of applicants into a medical school in their U6, and almost everyone in after a gap year if they decide to apply again.

What is in the course?

We follow the AQA A-level, and it does not matter if you have studied Dual or Triple Award at GCSE. The course consists of 8 units over the two years, 12 core skills and practicals (key experiments you have to do, and write up, including statistics, fieldwork, dissections and biochemical assays) and 3 external exams at the end of the Upper Sixth. In addition there are regular internal assessments: roughly one every half term, with an important exam at the end of the Summer Term of the L6. Students who do well in the course typically have:

- A high GCSE grade
- A willingness to work hard
- The ability to plan time and work outside of lessons
- Enthusiasm to get involved in things outside of lessons in the department
- The desire to use Biology to make a difference

If you have any more questions please get in contact with the school or ben.whitworth@abingdon.org.uk